

PROGRAM

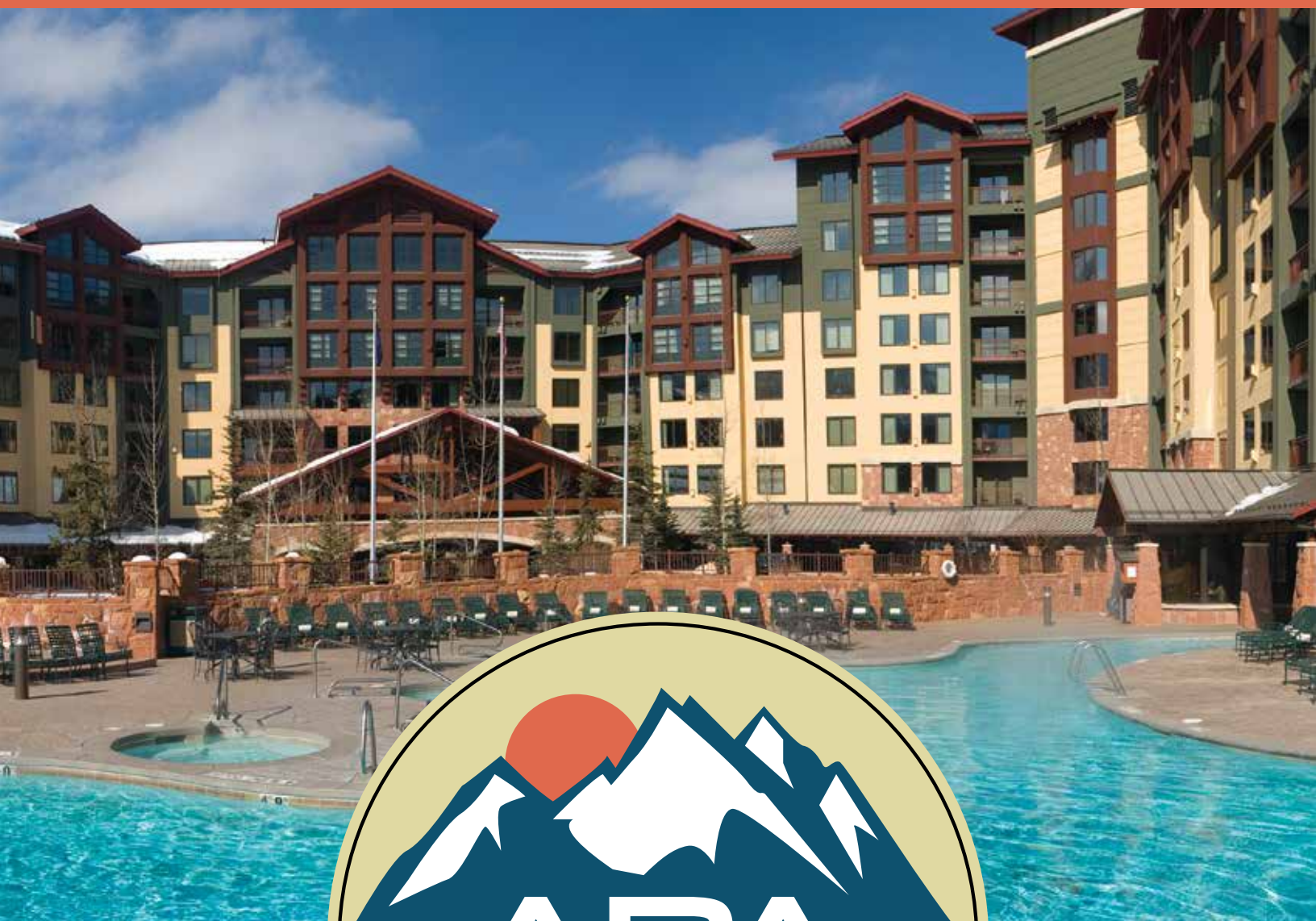

OCTOBER 25-28, 2024
2024 APA ANNUAL CONVENTION
Grand Summit Hotel – Park City, Utah



Your Connection Connection

Every product in the JVI Line is a result of attempting to improve the state-of-the-art of construction connections. JVI's mission and continuing quest, is the evolution of ever-improving solutions for making these connections.

PSA Slotted Inserts

Tie-Back Connection for Precast Panels



The Original PSA slotted insert is available in both "J" Finish (shown) or Stainless Steel

- White Cap - 6049**
 - 1 1/2" sq. nut
 - Slot adjustment 4 1/2"
 - Threaded strap anchor
- Red Cap - 6055**
 - 1 1/2" sq. nut
 - Slot adjustment 4 1/2"
 - Threaded strap anchor
- Black Cap - 6065**
 - 2" rectangular nut
 - Slot adjustment 3 1/2"
 - Threaded strap anchor

The M-series slotted insert is available in "J" Finish only

- White Cap - M62**
 - 1 1/2" sq. nut
 - Slot adjustment 4 1/2"
 - Threaded strap anchor
- Red Cap - M63**
 - 1 1/2" sq. nut
 - Slot adjustment 4 1/2"
 - Threaded strap anchor
- Black Cap - M64**
 - 2" rectangular nut
 - Slot adjustment 3 1/2"
 - Threaded strap anchor

The M-series slotted insert is available in "J" Finish only

- Green Cap - M66J**
 - 3/8 inch slotted with nut
 - Slot adjustment 4 1/2"
 - 2.53" inch overall depth
 - Notched strap

NOTE: Since strap capacity is the limiting strength factor in the fastening system, the notched strap is suitable **ONLY** in concert with the M66J insert.

Vector Connector

4 inch Minimum Pretopped Double Tee



The Vector Connector is available in both "J" Finish or Stainless Steel

- "J" Finish**
 - Faceplate height 1.5 inch
 - Faceplate tipped to 5°
- Stainless Finish**
 - Faceplate height 1.5 inch
 - Faceplate tipped to 5°

Vector Connector Blockouts

- Flexible rubber/plastic
- Reinforce

The mini-V Connector

2 inch Field Topped Double Tee



The mini-V Connector is available in both "J" Finish or Stainless Steel

- "J" Finish**
 - Angle
 - Faceplate tipped to 10°
- Stainless Finish**
 - Angle
 - Faceplate tipped to 10°
- Square**
 - Faceplate height 1 inch

Mini-V Blockouts

- Flexible rubber/plastic
- Reinforce

SHOOTER

Double T to Wall Panel Connection



The **Shooter** is an invisible, gravity connection designed to eliminate the need for aesthetically undesirable cables, hangers, or clips when building a precast/precast concrete structure incorporating double tees.

- Mechanical Design Strength of 40 kips

RVK/TSS

Stair Connection

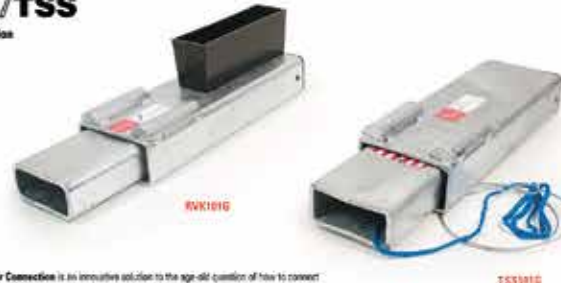

The **RVK/TSS Stair Connection** is an innovative solution to the age-old question of how to connect precast concrete staircases. It is a standard prefabricated connection used between stair landing and walk, present into concrete slabs.

- 30" Mechanical and reduces "stair noise"
- RVK/TSS 101G design mechanical capacity 22 kips
- TSS 41G design mechanical capacity 9 kips

Spider Plate

Substitute for a 6" x 6" embed plate with 4 studs



The **Spider Plate** is available in both "J" Finish (shown) or Galvanized Steel.

Available in two depths (1 1/2" and 2 1/2") and is manufactured with a "rubber tunnel hole" which allows the steel to add supplemental reinforcing to satisfy edge conditions without requiring welding.

MASTICORD™



The **MASTICORD™** random oriented fiber (ROF) and rubber composition pad is used primarily in precast concrete structural applications, but is also used in short-span precast concrete bridges and structural steel bearings.

- Fiber reinforced engineered bearing pad
- High compressive loading capacity - up to 16,000 PSI
- Stock Sizes: 1/2", 1 1/2", 1 1/2", 2", 2 1/2", 3", 4", 6", 8", 10", 12", or call for custom sizes

NEWION™

SHIMMERS™



Capalon™, available in Plain or PTFE coated for slide bearings, is a high capacity S-shaped duct lined bearing pad for commercial and highway bridge applications.

Newion™ is molded neoprene or natural rubber bearing pads conforming to current AASHTO specifications for highway bridges.

Shimmers™ are solid, laminated, high strength plastic shims for vertical adjustment during erection of precast panels.



Your Connection Connection

2131 North Ridgeway Avenue • Lincolnwood, IL 60712 USA
847-675-1560 • 1-800-742-8127 • www.jvi-inc.com



Additional product types and finishes also available. Visit www.jvi-inc.com for a complete line of JVI supplied products, details and engineering information.

Disclaimer: The use of JVI connections should be approved by a qualified professional engineer or architect.

WELCOME ATTENDEES

2024 APA ANNUAL CONVENTION

Welcome to the APA 2024 Annual Convention! We're thrilled that you can join us. Be sure to join us at the Welcome Reception and Dinner for a bourbon tasting from High West Distillery. Enjoy a great meal, taste some of High West's award-winning bourbon and take a chance at winning some High West swag by testing your knowledge of distilled spirits!

GENERAL INFORMATION

Schedule of Events & Hotel Map

A detailed Schedule of Events is located on pages 5 & 6 of this program and includes information on the educational sessions and events taking place during the convention. To assist you in locating the sessions and events, a layout of the Grand Summit is located below.

Please see an APA team member at the registration desk if you have any questions or need assistance during the convention.

Name Badge Information

Be sure to wear your name badge at all times. Your badge is your ticket to attend all events during the convention.

Event Tickets

Beverage tickets for the Friday, Saturday and Sunday evening events are included behind your name badge if you have pre-registered for these events or if you have purchased a Full Registration. Additional guest registrations for all events may be purchased at the APA registration desk.

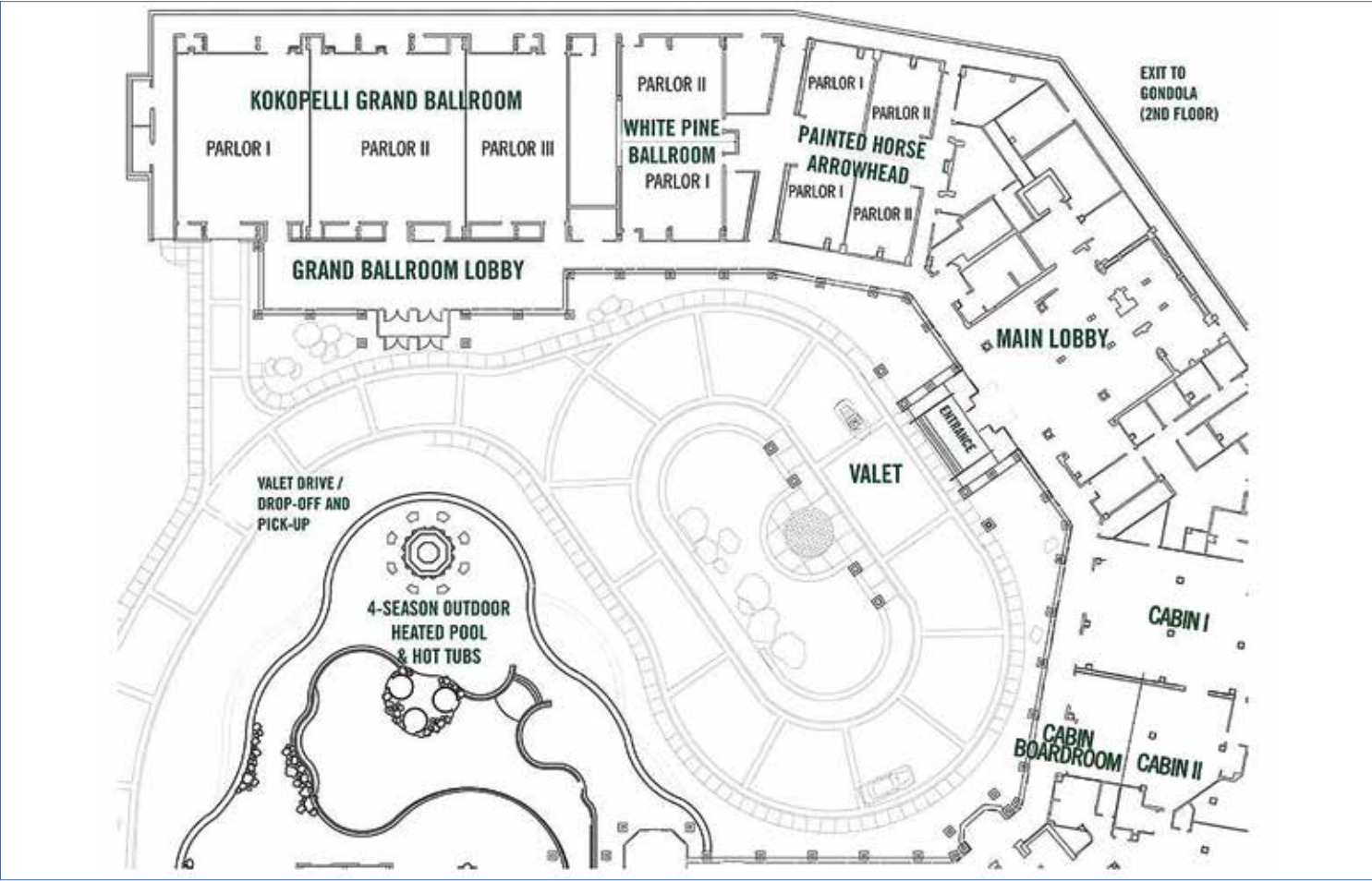

THANK YOU 2024 SPONSORS

(as of 10/7/24)

PLATINUM



GOLD



SILVER



TABLETOP DISPLAYS



ATTENDEE LANYARDS



SATURDAY COCKTAIL RECEPTION



T-SHIRT





2024 APA ANNUAL CONVENTION

October 25–28, 2024

Grand Summit Hotel – Park City, Utah

FRIDAY, OCTOBER 25

2:00 p.m. – 5:00 p.m.	APA Board of Directors Meeting (Arrowhead - Parlor I)
3:30 p.m. – 5:30 p.m.	Vendor Registration & Tabletop Display Setup (Kokopelli Grand Ballroom)
4:30 p.m. – 6:00 p.m.	Attendee Registration Desk Open (Kokopelli Ballroom Lobby)
6:30 p.m. – 8:30 p.m.	Opening Night Dinner and Bourbon Tasting (Red Tail Grill)

SATURDAY, OCTOBER 26

8:00 a.m. – 12:00 p.m.	Registration Desk Open (Kokopelli Ballroom Lobby)
8:00 a.m. – 12:00 p.m.	Associate Displays Open (Kokopelli Ballroom)
8:30 a.m. – 9:00 a.m.	General Membership Meeting (Kokopelli Ballroom)
9:00 a.m. – 9:15 a.m.	Sponsor Presentations (Kokopelli Ballroom)
9:15 a.m. – 10:15 a.m.	GENERAL SESSION I: “We Will Not Be Landing in Seattle” Lessons in Leadership from Captain “Sully” Sullenberger’s Landing of U.S. Airways Flight 1549 on the Hudson River (1 CEU) Presenter: Stephanie Giesler, Vistage Chair
10:15 a.m. – 10:45 a.m.	Associate Displays Open / Beverage Break (Kokopelli Ballroom)
10:45 a.m. – 11:00 a.m.	Sponsor Presentations (Kokopelli Ballroom)
11:00 a.m. – 12:00 p.m.	GENERAL SESSION II: Making the Complex Look Easy – Case Studies in Forms and Mold Making (1 CEU) – Part 1 APA Producers will share their experiences with brief presentations and facilitated discussions on complex jobs that required unique and challenging molds. Moderator: Jesse Thompson, President/Owner, Northern Design Precast Presenters: Eric Sutliff, General Manager, DeVinci Precast <i>Greenwood Rising Museum, Tulsa, OK</i> Jonathan Luse, Sales Engineer, Scott System Mario Gutierrez, National Sales, Scott System <i>Pier 55 / Little Island, New York, NY</i>
12:00 p.m. – 12:30 p.m.	Associate Member Meeting (Kokopelli Ballroom)
12:30 p.m. – 6:00 p.m.	Afternoon on Your Own
6:00 p.m. – 7:00 p.m.	Cocktail Reception (The Cabin I)
7:00 p.m.	Dinner on Your Own

SCHEDULE OF EVENTS

SUNDAY, OCTOBER 27	
8:00 a.m. – 11:15 a.m.	Registration Desk Open (Kokopelli Ballroom Lobby)
8:00 a.m. – 11:00 a.m.	Associate Displays Open (Kokopelli Ballroom)
8:30 a.m. – 9:30 a.m.	<p>GENERAL SESSION III: Making the Complex Look Easy – Case Studies in Forms and Mold Making (1 CEU) – Part 2</p> <p>APA Producers will share their experiences with brief presentations and facilitated discussions on complex jobs that required unique and challenging molds.</p> <p>Presenters: Parker James, Marketing, Sales & Loss Control Coordinator, Castone Corporation <i>Huntsville City Hall - Huntsville, AL</i></p> <p>Matt Gehring, Director of Operations, Unlimited Designs Dustin Williams, Director of Project Management, Unlimited Designs <i>Populous Hotel – Denver, CO</i></p>
9:30 a.m. – 9:45 a.m.	Sponsor Presentations (Kokopelli Ballroom)
9:45 a.m. – 10:15 a.m.	Associate Displays Open / Beverage Break (Kokopelli Ballroom)
10:15 a.m. – 10:30 a.m.	Sponsor Presentations (Kokopelli Ballroom)
10:15 a.m. – 11:15 a.m.	<p>GENERAL SESSION IV: Producer Roundtable Discussions (1 CEU)</p> <p>Facilitated roundtable discussion where producers share and discuss challenges they face, innovations in precast, new technologies and other relevant topics.</p>
11:15 a.m. – 12:00 p.m.	Tabletop Displays Breakdown
12:30 p.m.	10th Annual JBT Championship Golf Tournament (Wasatch Mountain Golf Course) The Cure Starts Now Fundraiser
6:30 p.m. – 8:30 p.m.	APA Awards for Excellence Dinner & Ceremony (Kokopelli - Parlor I & II)
MONDAY, OCTOBER 28	
8:00 a.m. – 1:30 p.m.	Plant Tours of Unlimited Designs and Olympus Precast (2 CEU) (Pre-registration is required – APA will provide additional information to those who register)
8:00 a.m.	Bus departs from Hotel, Travel to Olympus Precast – Salt Lake City
9:20 a.m. – 10:35 a.m.	Plant Tour of Olympus Precast and light breakfast (1 CE Credit)
10:40 a.m. – 11:10 a.m.	Travel to Unlimited Designs – Salt Lake City
11:15 a.m. – 12:20 p.m.	Tour Unlimited Designs (1 CE Credit)
12:20 p.m. – 12:30 p.m.	Travel to Salt Lake City International Airport
12:30 p.m.	Bus departs for Hotel
1:30 p.m.	Bus arrives at Hotel



Do you have questions about the architectural precast process or about our company?

Contact us!

Phone: (603) 783-8989

Website: <https://ndprecast.com/>

Northern Design Precast, Inc.

51 International Drive, Loudon, NH 03307

JOHN BRADLEY THOMPSON - THE CURE STARTS NOW



In June of 2013, the Jesse Thompson family was delivered the devastating news that their son, John Bradley had a Diffused Intrinsic Pontine Glioma (DIPG), an inoperable brain tumor that affects less than 300 kids per year and yields just a 2% survival rate. John, his family and his community banded together for ten months, but sadly, John lost his battle in April 2014.

Many believe that DIPG holds the secret to curing most, if not all, forms of cancer. The Cure Starts Now Cancer Foundation is one of the only cancer foundations dedicated to finding a "homerun" cure. However, this particular form of Pediatric Brain Cancer research receives little to no federal funding since there are so few kids diagnosed on a yearly basis (approximately 300). No parent should ever be delivered this devastating news. The money raised through The Cure Starts Now is used in the best possible manner, minimizing wasted spending and fighting cancer on knowledge and research, not just the numbers. Because of this experience, the Thompson family is heavily involved with the foundation and APA would like to show their support as well. If you would like to support this worthwhile cause, donation forms are available at the APA registration desk.



THE CURE STARTS NOW®
www.thecurestartsnow.org

Voeller has been offering mixing and batching solutions for concrete producers for 50+ years. We continue to listen to the input of our clients, adding innovative new features to our mixers but one thing hasn't changed: our commitment to delivering a reliable product that improves production, quality, and speed.



What Voeller has to offer

- Pan Mixers
- Planetary Mixers
- Turnkey Batch Plants
- Cement Silos
- Aggregate Silos/Bins
- Conveyors
- Skip Hoists
- Aggregate Heating
- Retrofit Systems



Setting the standard for excellence and quality in the casting industry. Our attention to detail is unsurpassed, resulting in exceptional quality and outstanding customer service.

What parts Texaloy has to offer

- Concrete Mixers (Besser, Teka, Mixer Systems, Praschak, Simem, Sicoma, Skako and many more)
- Concrete Pipe Machines
- Augers
- Shotcrete/Gunite
- Other industrial castings



VOELLERMIXERS.COM • PORT WASHINGTON, WI • 262-284-3114
TEXALOY.COM • FLORESVILLE, TX • 830-393-4066



INNOVATION
SINCE
1946



TRUSTED BY PRECASTERS WORLDWIDE



PREMIUM RELEASE AGENTS

FOR ICONIC RESULTS IN
ARCHITECTURAL CONCRETE

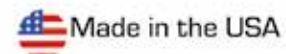

north america's most preferred brand: release agents ■ form treatments ■ cures & seals cresset.com

SATURDAY OPENING KEYNOTE

We Will Not Be Landing in Seattle

Presenter: Stephanie Giesler, Vistage Chair

One of the most important leadership skills is knowing when to change course and courageously making those course corrections in real time, despite pressure and less than ideal information. Our brains are wired to not want to give up on a previously planned destination, even when all the signs tell us we must.

On January 15, 2009, Captain Chesley “Sully” Sullenberger taught valuable lessons in leadership. He landed U.S. Airways flight 1549 in the Hudson River, saving the lives of all 150 passengers and crew. After the unexpected bird strike shortly after takeoff that took out both engines, Sully had just four minutes to process the options and lead his crew through a successful water landing.

How did Captain Sully become a hero that day? The odds were not in his favor.

About Stephanie Giesler

Stephanie Geisler, is an accomplished Vistage Chair and Executive Coach with extensive experience in fostering collaboration among business leaders and driving personal and organizational growth.

With a passion for helping individuals and organizations reach their full potential, Stephanie brings a wealth of knowledge in change management, team management, technology management, career development, and more.

As a Vistage Chair, Stephanie works with business owners and CEOs dedicated to enhancing their business performance and personal lives.



Stephanie Giesler

SATURDAY CASE STUDIES

Making the Complex Look Easy – Case Studies in Forms and Mold Making – Part 1

Julius Caesar said, “experience is the best teacher” and during this interactive session, APA Producers will share their experiences with brief presentations and facilitated discussions on complex jobs that required unique and challenging molds.

Moderator:

Jesse Thompson, President/Owner, Northern Design Precast

Presenters:

Eric Sutliff, General Manager, DeVinci Precast
Greenwood Rising Museum, Tulsa, OK
Jonathan Luse, Sales Engineer, Scott System
Mario Gutierrez, National Sales, Scott System
Pier 55/Little Island, New York, NY



MEET THE SPEAKERS

SUNDAY CASE STUDIES

Making the Complex Look Easy – Case Studies in Forms and Mold Making – Part 2

Julius Caesar said, “experience is the best teacher” and during this interactive session, APA Producers will share their experiences with brief presentations and facilitated discussions on complex jobs that required unique and challenging molds.

Moderator:

Jesse Thompson, President/Owner, Northern Design Precast

Presenters:

Parker James, Marketing, Sales & Loss Control Coordinator
Castone Corporation

Huntsville City Hall - Huntsville, AL

Matt Gehring, Director of Operations, Unlimited Designs
Dustin Williams, Director of Project Management, Unlimited Designs

Populous Hotel, Denver, CO



SAVE THE DATE

2025 Annual Convention
Sept. 25-30, 2025

Stephen F. Austin
Royal Sonesta Hotel

701 Congress Ave
Austin, TX 78701

DON'T MISS OUT

APA Spring Workshop
May 1 – 4, 2025
Portsmouth, NH

Host Plant
Northern Design



When it comes to **GFRC**, it's got to be **Power-Sprays**

POWER-SPRAYS

Find out why Glass Fiber Reinforced Concrete production experts across the globe use Power-Sprays equipment:

www.power-sprays.com



Represented by **Trinic LLC**
in the United States



It's time to

Rethink Concrete Color.

Transformative Precast Stain –

Available in Any Color or Finish You Choose

Nawkaw
ARCHITECTURAL FINISHES INSPIRED BY ART & SCIENCE

CONVENTION ACTIVITIES

Opening Night Event

Friday, October 25 - 6:30PM – 8:30 PM

Grand Summit Resort – Red Tail Grill

Start your 2024 APA Annual Convention on a high note with dinner and a delightful bourbon tasting event. Savor delicious food, network, and indulge in some amazing bourbon from the internationally recognized, award winning brand High West Distillery.



Copyright 2024 High West Distillery

10th Annual JBT Championship Golf Tournament

Sunday, October 27, 2024 – 12:30 PM

Wasatch Mountain Golf Course

975 Golf Course Dr,

Midway, UT 84049

<https://stateparks.utah.gov/golf/wasatch/>

Network with colleagues as you enjoy a round of golf and support this great charity event. If you would like to play, please go to the APA Registration Desk to register. If you would like to donate to The Cure Starts Now Foundation in memory of John Bradley Thompson, please visit the APA registration desk for more details.

The well-known Mountain and Lake courses at Wasatch Mountain State Park are consistently ranked among the most popular, affordable, and scenic in Utah. Nationally, Golf Digest rated Wasatch Mountain as one of Utah's Best Places to Play!

The course is about a 30-minute drive from the hotel. Transportation is on your own, but if you need a ride, please stop by the registration desk.



Copyright 2024 Wasatch Mountain Golf Course

APA Awards for Excellence Dinner & Ceremony

Sunday, October 27 – 6:30 PM – 8:30 PM

Grand Summit Resort

Kokopelli – Parlors I & II

Please join us for the closing dinner as we celebrate and honor the remarkable achievements of individuals in the industry.





PLANT TOURS

MONDAY, OCTOBER 28 – 8:00 A.M. – 12:30 P.M.

Plant Tours of Olympus Precast and Unlimited Designs – Salt Lake City (2 CE Credits)

(Pre-registration is required – APA will provide additional information to those who register.)

Note: The tour will include breakfast at Olympus Precast and transportation to the airport at the end of the tour. The bus will leave promptly at 8am. Please meet in the hotel lobby at 7:45am. If your last stop is the airport please remember to bring your luggage with you. The bus will return to the hotel after the drop off at the airport.

Olympus Precast

Olympus Precast, formerly known as Owell Precast, started in the precast concrete industry over twenty five years ago with an unwavering attention to quality, safety and integrity. Driven by its guiding principles of unparalleled customer service, a commitment to excellence and on-going technical advances Olympus is one of the most highly regarded precast producers in the western states.

Unlimited Design

Ancient Romans may have been the first to use concrete as a building material, but the professionals at Unlimited Designs, Inc. have improved the process. UD evolved from a construction company in 1994 where our background involved the installation of many products that they now manufacture and distribute. They realized that quality products that were easy to install would save consumers both time and money.

That is why today, Owners, Builders and Installers, turn to them for their innovative, cost-effective and maintenance free products. Their products have the same great detail and class as the architecture of old.





APA MEMBER BENEFIT: HR & EMPLOYMENT HOTLINE



As valued association members of the Architectural Precast Association, you have unlimited access to a complimentary HR & Employment HOTLINE through our partnership with **Seay Management Consultants**. This HR & Employment HOTLINE is available to you at NO COST and will provide answers to your human resources, personnel management and employment related questions.

Hundreds of employee questions arise in day to day business and almost every one of them can be different – questions about COBRA, FMLA, EEOC, ADA, and so many others. Sometimes a simple question can turn into a complicated or costly concern

if it's not handled properly.

When you have a question and need an accurate, straight forward answer, simply contact Seay Management Consultants and identify yourself as an APA member.



HR & EMPLOYMENT HOTLINE

Email: admin@seay.us

Toll Free: 888-245-6272

HUMAN RESOURCES SPECIAL MANAGEMENT PROJECTS*

Employee Handbooks

Affirmative Action Plans

Equal Employment Opportunity

Resolving Discrimination Charges

HR Audits

Wage and Hour Analysis

Employee Opinion Surveys

Management Development

Supervisory Training

Compensation Management

Salary Administration Programs

Developing Job Descriptions

Americans With Disabilities

Employee Conflict Resolution

Sexual Harassment Prevention

Wage and Hour Investigations

HR Workshops and Presentations

**Special Projects will be offered at a reduced hourly rate for clients of APA.*

DID YOU MISS THE 2024 SPRING WORKSHOP? DON'T MISS OUT IN 2025!

The 2024 UHPC Workshop, held in Tacoma, WA, garnered remarkable support and attendance! The workshop included plant tours at Northwest Precast and Concrete Technologies, engaging educational sessions, and a scenic dinner cruise. More than 90 attendees received hands-on instruction in UHPC production as well as classroom instruction on the unique properties of UHPC, the business cases for using UHPC and more.

We have a great event planned for next year, so mark your calendar now for the 2025 Spring Workshop, May 1-4 in Portsmouth, NH!

To see all photos from the 2024 event use the following link: <https://dropevent.com/APA2024SpringWrkshp>



EDUCATION AND
HANDS ON
INSTRUCTION



CONNECTIONS AND CONVERSATIONS



Nothing Protects a Form Like a Coat of Armor...

ARMORGARD 505

EPOXY FORM COATING

VERSATILE - Bonds to wood, concrete, steel & Styrofoam

MORE ECONOMICAL - Single coat application

SAFER - No VOCs, No Solvents

STRONGER - Outlasts fiberglass and urethane

Now available in clear or dark red formulations!

Please Call for FREE Samples, Pricing
and Immediate Shipping.



Call FISTER, Inc 800-339-9534 / Fax 770-587-2321

FISTER
www.fisterinc.com

Protect your Forms and Profits with Armorgard

WE ARE ALL AROUND THE GLOBE

Spreading innovation
and inspiration
in building
materials
technologies.

More
than
70
Countries

3
Continents

5 Integrated
plants in Turkey,
Spain & USA*

1 white cement facility in the **USA**
4 international terminals

*The Grey Cement Plant will be operational in 2025.



www.cimsa.com.tr



[/company/cimsa](https://www.linkedin.com/company/cimsa)



[/cimsacement](https://www.facebook.com/cimsacement)



[/cimsacement](https://twitter.com/cimsacement)



[/cimsacement](https://www.instagram.com/cimsacement)

ÇİMSA
AMERICAS





For your architectural needs, when **gray**
just isn't good enough, think

FEDERAL WHITE CEMENT
for a **whiter** and **brighter** appearance.

Available in both portland and masonry cements.
For more information call 800-265-1806 or visit our website:
www.federalwhitecement.com

FEDERAL WHITE CEMENT
P.O. BOX 1609
WOODSTOCK, ONTARIO N4S 0A8